

Product Datasheet

RPU3005

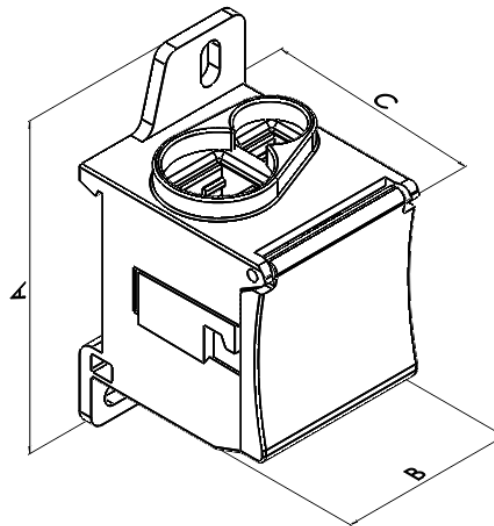

Main

Family	Compact Distribution Blocks	
Version	1 Pole	
Code	RPU3005	
Reference	RPU 160-8 S	
Number per package	1	
In(A)	IEC/EN	160 A
	UL	175 A
Weight (Kg)	0.170	
A (mm)	75	
B (mm)	40	
C (mm)	48	

Technical Data

Type	1 Pole 8 outputs 160 A						
160 A	COFLEX* L(mm)	Stripped wire (mm ²)	Wire with ferrule (mm ²)	No.	Dim. (mm)	Screw dimension	Torque (Nm)
IN	9 - 13	10 ÷ 70	10 ÷ 50	1	13.5x11.5	M10	10
IN/OUT	-	6 ÷ 16	6 ÷ 16	1	8.7x6	M6	3
OUT	-	2.5 ÷ 16	2.5 ÷ 16	8	∅ 6.8	M6	3
I _{cw} (kA)	11						
I _{pk} (kA)	30						
U _i (V)	1000						

I_{cc pk} = Short-circuit current peak value expressed in kA

I_{cw} = Effective value of short-circuit current, duration equal to 1 second, expressed in kA as per standard IEC 60947-7-1

U_i = Nominal Insulation voltage

*See COFLEX technical features

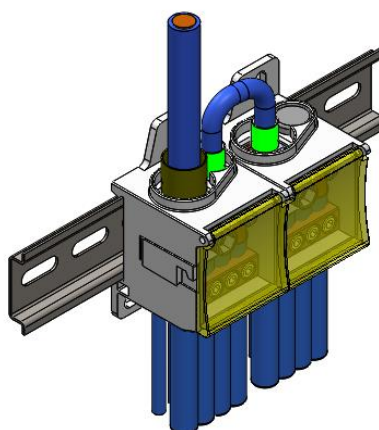

Technical Features

Insulating body: PA 6 UL 94-V0 halogen free, gray RAL 7035.

Cover: PC UL 94-V2 halogen free, transparent yellow

Conduction block: Tinned copper

Clamps: Galvanized steel and Al alloy

Screws: Galvanized steel

Index protection IP20 guaranteed with the following minimum requirements:

- IN: COFLEX dimensions
 - 6x9x0.8 or higher,
 - 10x13x0.5
- IN/OUT: 10mm² cables or larger
- All inlet/outlets are connected and cables and/or COFLEX are unsheathed for the minimum necessary length.

Continuous working temperature: -30°C ... +75°C

Compliant with standard IEC 60947-7-1

UL 1059 standard recognized.

Please contact Teknomega for non-specified tolerances.